

Fallimenti **LOTTO 5** e ASTE

ALLEGATO "B"

INDIVIDUAZIONE LOTTO

Teramo, 29.02.2024

Gli esperti estimatori

Geom. Osvaldo Reginelli



Geom. Gianfranco Giuliani



Geom. Serena Vanarelli



Strada statale 150

P.Ila 131

P.Ila 306

P.Ila 358

P.Ila 288

P.Ila 328

P.Ila 328

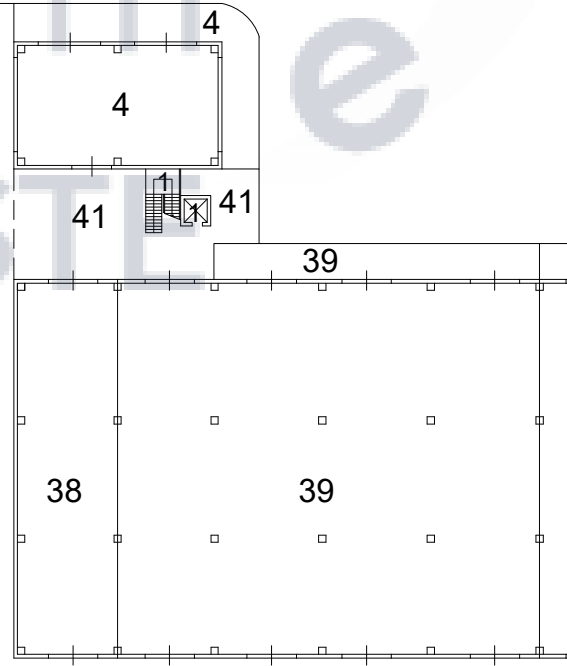

P.I.

Fallimenti e
ASTE

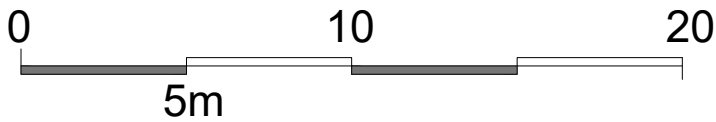
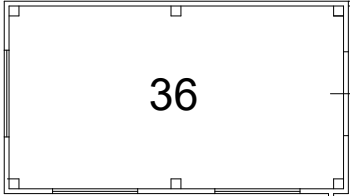

ALLEGATO "C"

RILIEVO-DOCUMENTAZIONE COMUNALE-STATO DEI LUOGHI

Fallimenti e
ASTE

Teramo, 29.02.2024

Gli esperti estimatori

Geom. Osvaldo Reginelli



Geom. Gianfranco Giuliani



Geom. Serena Vanarelli



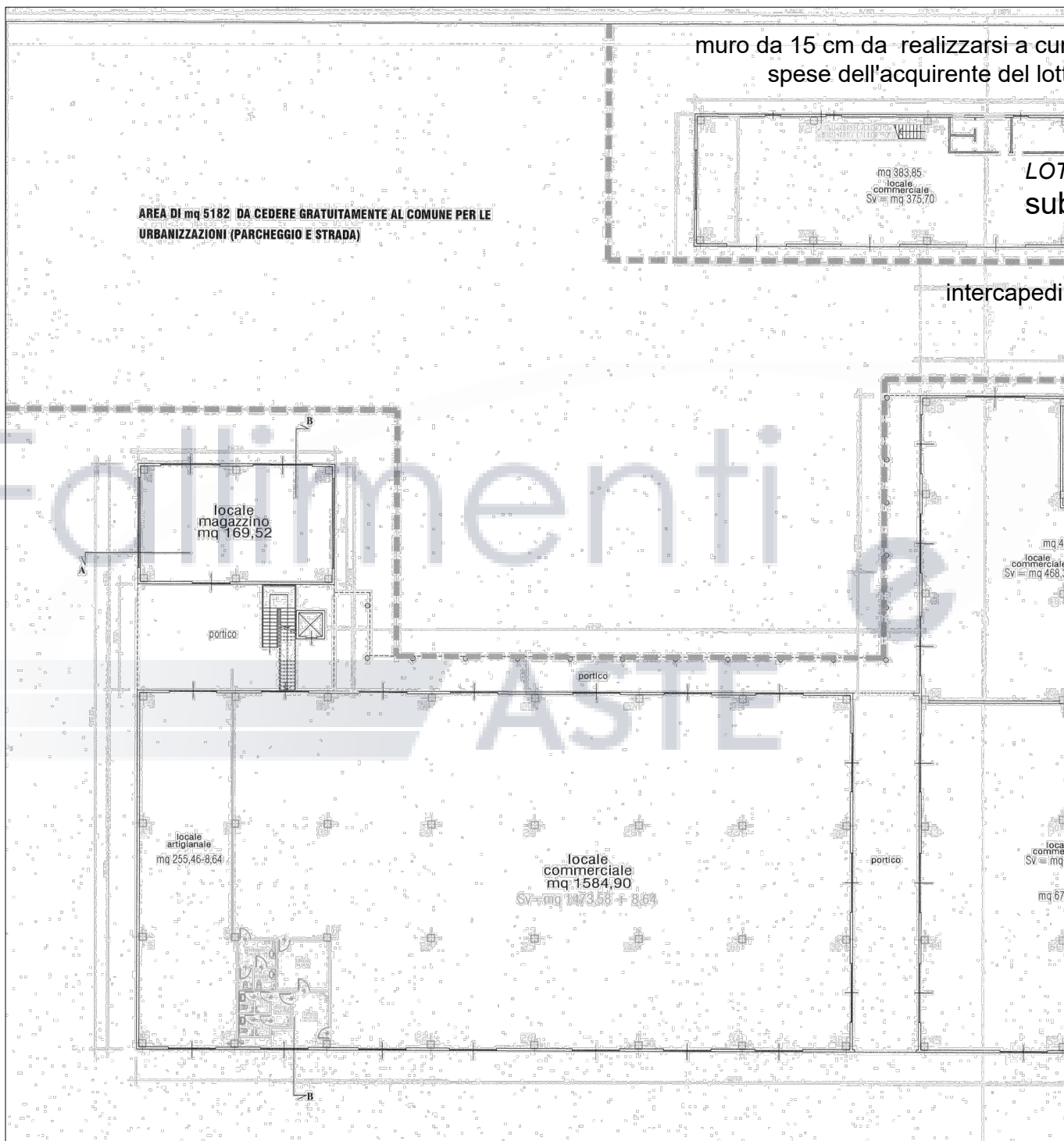

Piano Terra

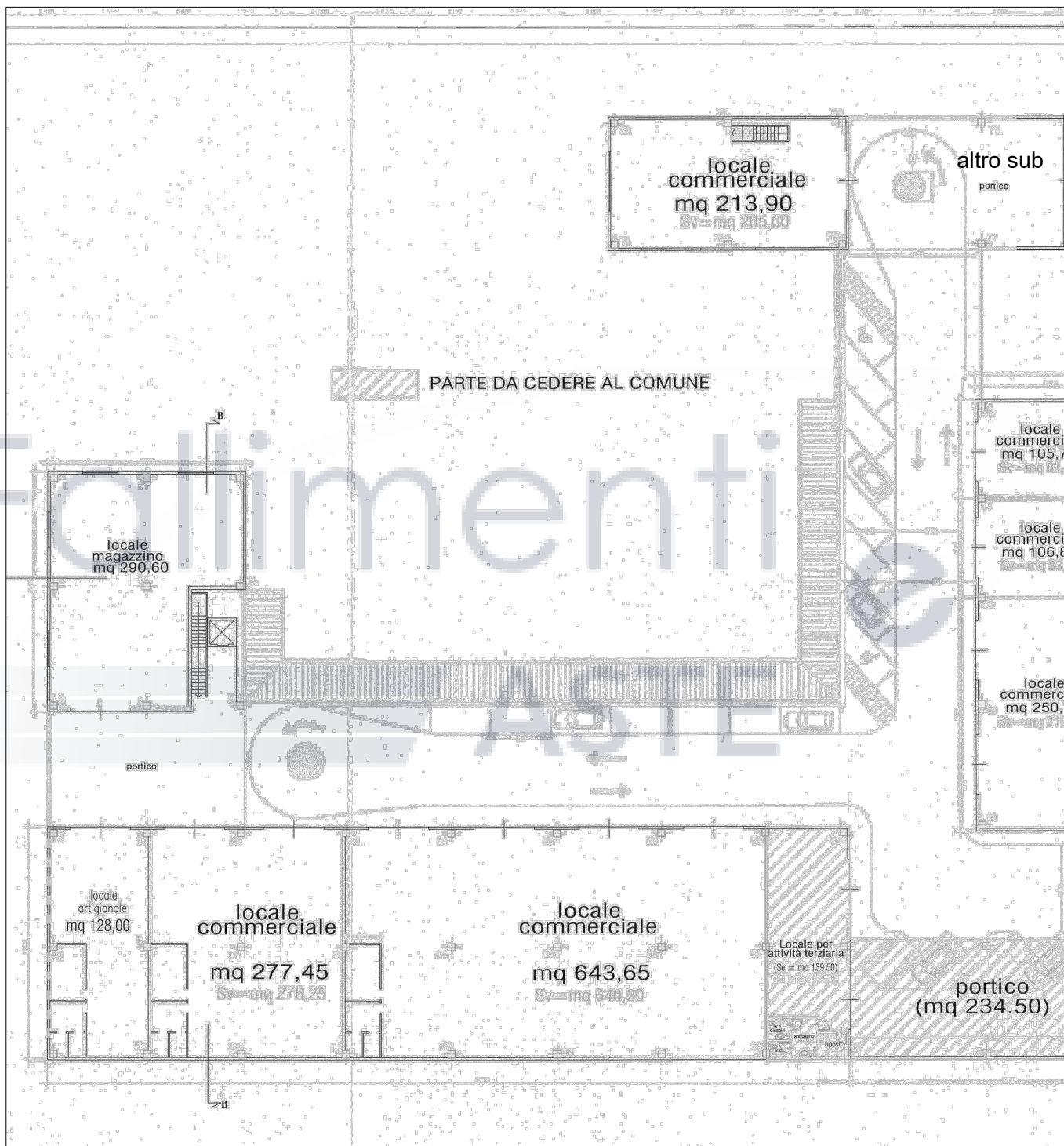

Piano Primo